

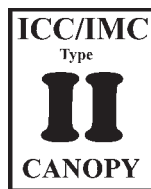

CANOPIES, UPDRAFTS, DUCTWORK, EXHAUST AND MAKE UP AIR FANS



**APPROVAL  
SHEET**



Standard 2

# Type II Steam Canopys

## With Rear Untempered Make Up Air Wall Paneling

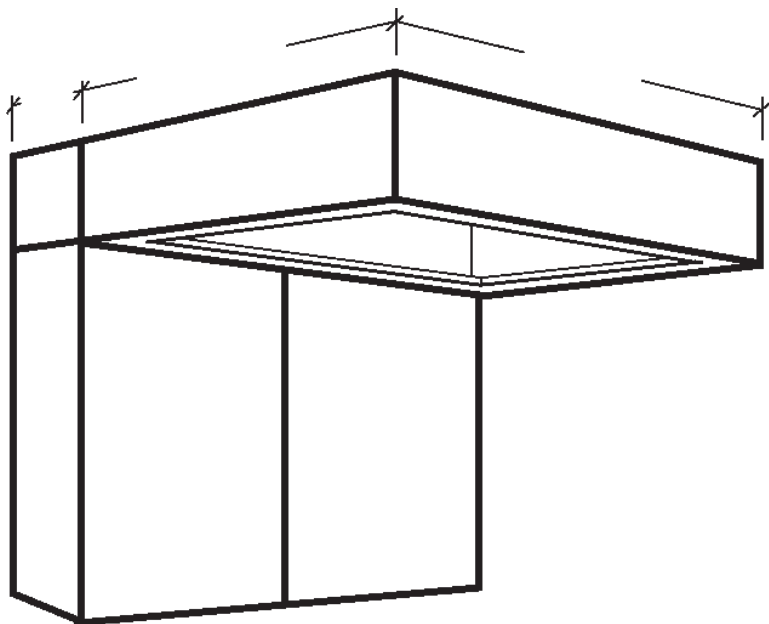

Job Name:		
Dealer:		
Canopy Model	By:	Date:
<b>Fabrication cannot begin until sheet is signed</b>		
Approved by	PO Number	Date

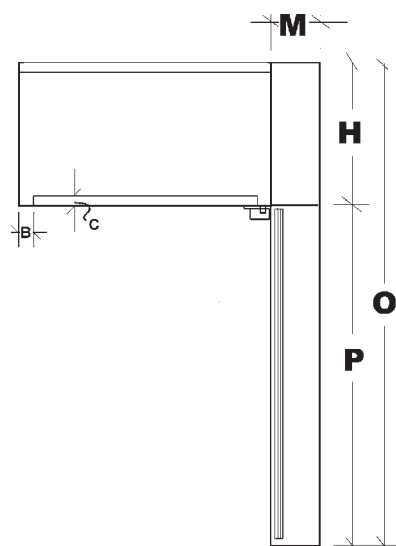

Dimensional Data					
H	M	P	O	B	C
				2"	3/4"

### Specifications

**Sturdi-Bilt TYPE II Steamer Canopy** Constructed of all 300 Series 18/8 Nickel Chrome Stainless Steel. Full perimeter Condensate Gutter with Drain and condensate cup. Insulated S/S Where Shows Rear Wall Plenum/Paneling for Untempered Make Up Air. Top has Threaded Rod Hanger Brackets at Front and rear. NSF Listed. Built to International Mechanical Code Type II Hood Construction. Complete with Hanging Instructions.

- ☐ Lite Gauge Stainless Steel
- ☐ 18 Gauge Stainless Steel