

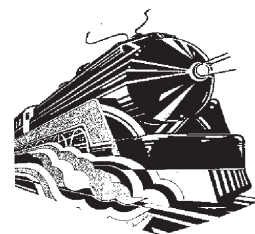

CANOPIES, UPDRAFTS, DUCTWORK, EXHAUST AND MAKE UP AIR FANS

APPROVAL SHEET



Economy Plate Shelf Updraft

Rear Untempered Make Up Air

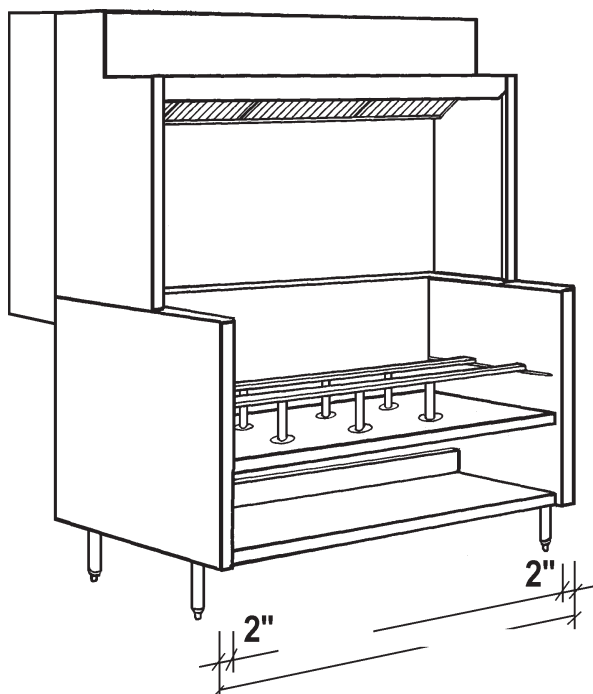

Job Name:

Dealer:

Updraft Model

By:

Date:

Fabrication cannot begin until sheet is signed

Approved by

PO Number

Date



NFPA#96



Standard 2

Options

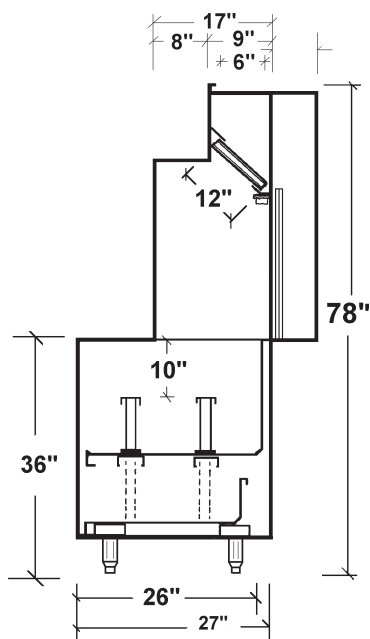

Specifications

Updraft Superstructure: constructed of Stainless Steel on all exposed surfaces.

Ventilation Section constructed of 20 Gauge Stainless Steel and 18 Gauge Aluminized Steel. All seams externally welded, Code #96 construction. Stainless Steel Plate Shelf, Back Panel and Top Ends. Includes a full complement of 20" wide U.L. Listed Aluminum Baffle Filters, pitched grease gutter, grease drain, and removable S/S covered grease cup. NSF Listed. Built to NFPA, Michigan, International Mechanical Code Specifications for Low Side Wall Hoods.

Updraft Equipment Base: double wall ends for easy cleaning. Interior Ends constructed of Stainless Steel. Finished Painted Hammertone Gray Exterior Ends. Stainless Steel Equipment Shelf, reinforced with aluminized steel channels. Stainless Steel Undershelf, adjustable NSF legs, and removable Equipment Rails for standard weight counter cooking equipment. NSF Listed.

Make Up Air: Untempered Make Up Air introduced behind Updraft in insulated air distribution plenum.

☐ **Aluminized Steel Model:** constructed the same as above, only with Aluminized Steel Interior Base Ends, and Aluminized Steel Undershelf.

☐ **Maple Cutting Board:** Laminated Hard Maple, 8" wide, mounted on Stainless Steel brackets. Board easily removable for cleaning.

☐ **Stainless Steel Ends:** supplied with Left &/or Rite S/S Exterior Base Ends.

☐ **UL/CSA:** UL 710 Labeled and Listed.



8132 Puritan Avenue, Detroit, Michigan, 48238, Phone Toll Free - 1-800-521-2895, Fax Toll Free 1-800-444-2895