

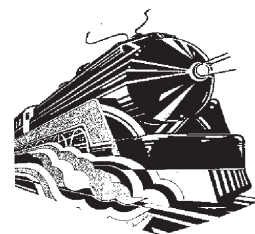

CANOPIES, UPDRAFTS, DUCTWORK, EXHAUST AND MAKE UP AIR FANS

# APPROVAL SHEET



*Economy*

## 24" Wide Low Side Wall Hood

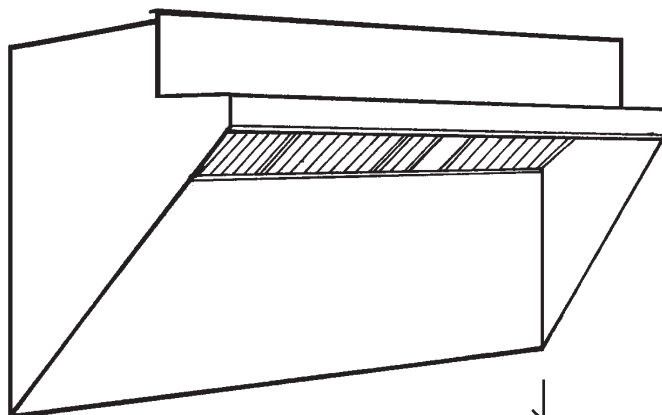

Job Name:		
Dealer:		
Updraft Model	By:	Date:
<b>Fabrication cannot begin until sheet is signed</b>		
Approved by	PO Number	Date

### Options

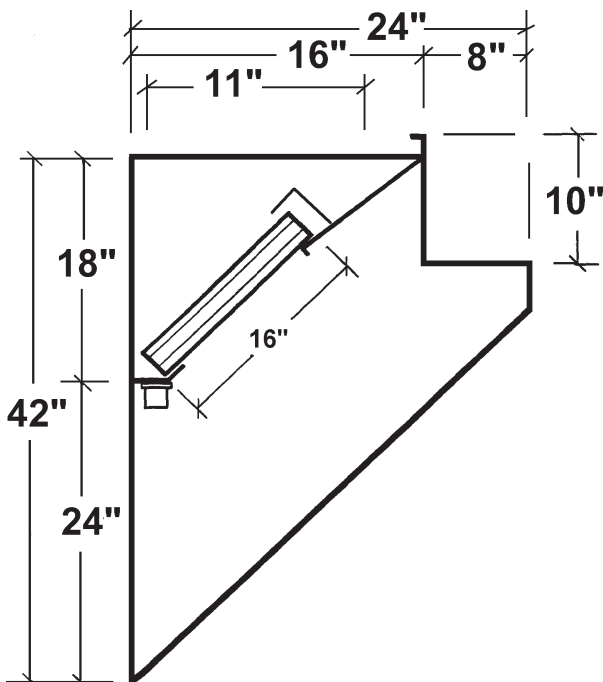

### Specifications

- ☐ **LSW73"S" Series:** Stainless Steel Model: Constructed of 20 gauge Stainless Steel where shows. Exhaust Section 18 gauge seamless Code #96 welded construction. 16" high Aluminum U.L. Listed Baffle Filters. Pitched grease trough to removable covered Stainless Steel grease cup. Complete with hangerstrap and instructions. NSF Listed, built to NFPA Code #96 and International Mechanical Code requirements for Type I Low Side Wall Hoods.
- ☐ **LSW73"A"24 Series:** Painted Model: Same as above except exposed exterior constructed of 18 gauge Aluminized coated Steel, exterior painted hammertone gray where shows.