

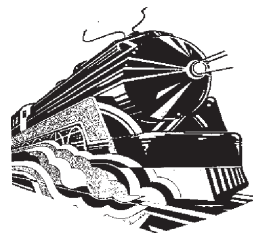

CANOPIES, UPDRAFTS, DUCTWORK, EXHAUST AND MAKE UP AIR FANS

APPROVAL SHEET

Economy



30" Wide Low Side Wall Hood

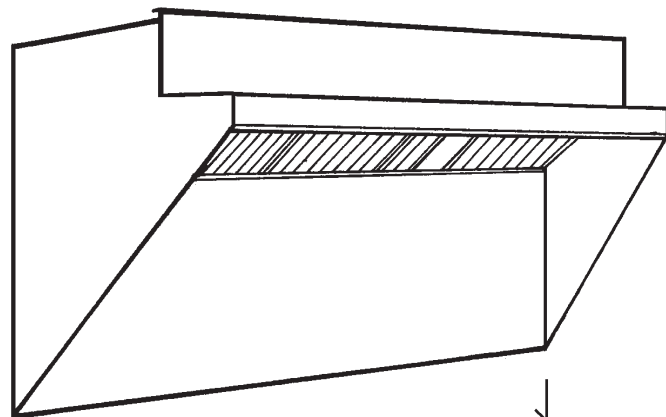

Job Name:

Dealer:

Updraft Model

By:

Date:

Fabrication cannot begin until sheet is signed

Approved by

PO Number

Date

Options



NFPA#96



Standard 2

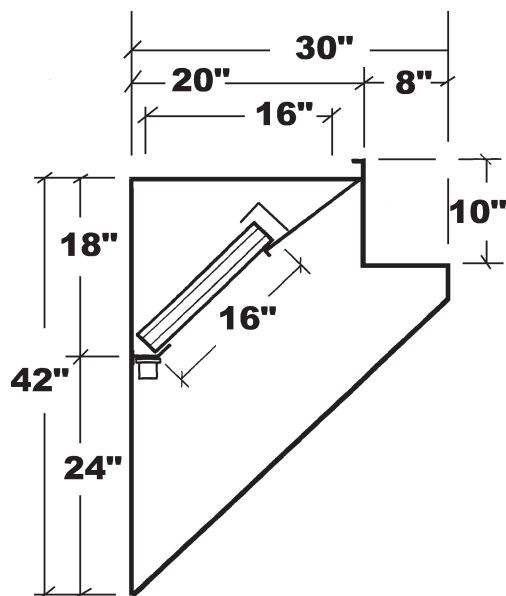

Specifications

☐ **LSW96"S" Series:** 30" Wide Stainless Steel Model: Constructed of 20 gauge Stainless Steel where shows. Exhaust Section 18 gauge seamless Code #96 welded construction. 16" high Aluminum U.L. Listed Baffle Filters. Pitched grease trough to removable covered Stainless Steel grease cup. Complete with hangerstrap and instructions. NSF Listed, built to NFPA Code #96 and International Mechanical Code requirements for Type I Low Side Wall Hoods.

☐ **LSW96"A" Series:** Painted Model: Same as above except exposed exterior constructed of 18 gauge Aluminized coated Steel, exterior painted hammertone gray where shows.

☐ **UL 710 and Canada**

☐ **CSA C22.2 No 113**
Exhaust Hood Recognized



**Can
CSA
C22.2**

UL 710